

Specification

Architecture lighting integration series

LR3735



LR3735





Features

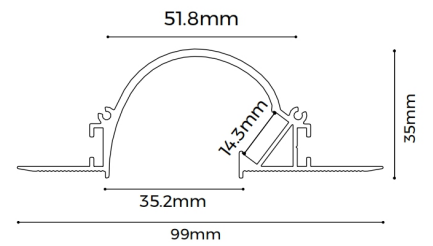

- 35mm luminous surface , rimless recessed design, integrated into architecture.
- AL6063-T5 aluminum profile with high-quality surface treatment.
- Indirect lighting design integrates architectural and lighting effects.



Standard Configuration

Picture	Item	Parameter
	Profile	Profile weight : 2.25kg/2.5m Size : L2500*W99*H35mm Material : AL6063-T5 Surface processing : Anodizing
	End caps	Size : L59.8*W35*H2mm Material : AL

Optional Accessories

Picture	Item	Parameter
	Flexible strip D8168-24V-10mm	Material :FPC,CCT:1900/2300/2700/3000/3500/4000/5000/6000K ; CRI > 90/>95 ;Voltage :24V ;Power :16.2W/m ;Lumen :1860Lm/m ; Width : 10mm ; Minimum cutting unit : 7LEDs/42mm ;
	Screw	Size : M3.5*40mm Material : Carbon steel

Optical Parameter

(D8S120-24V-12mm light source)

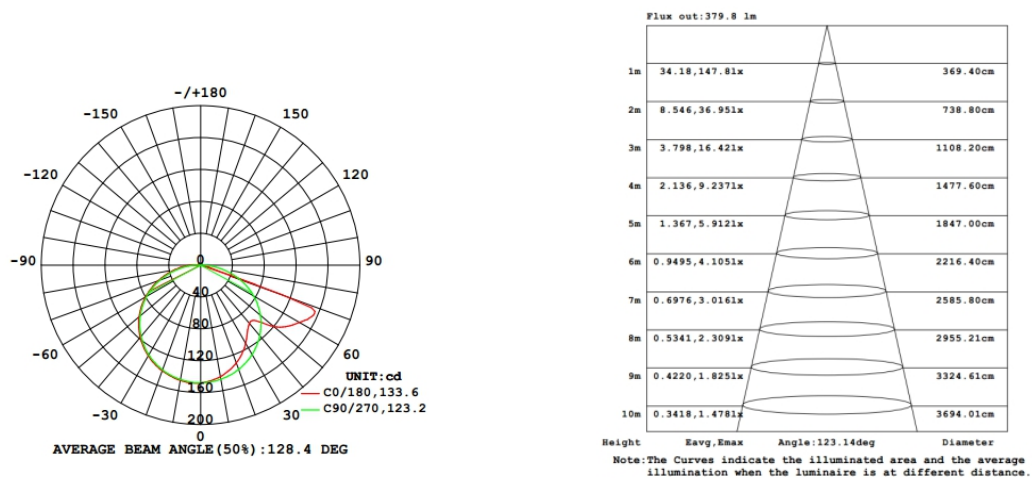

Package

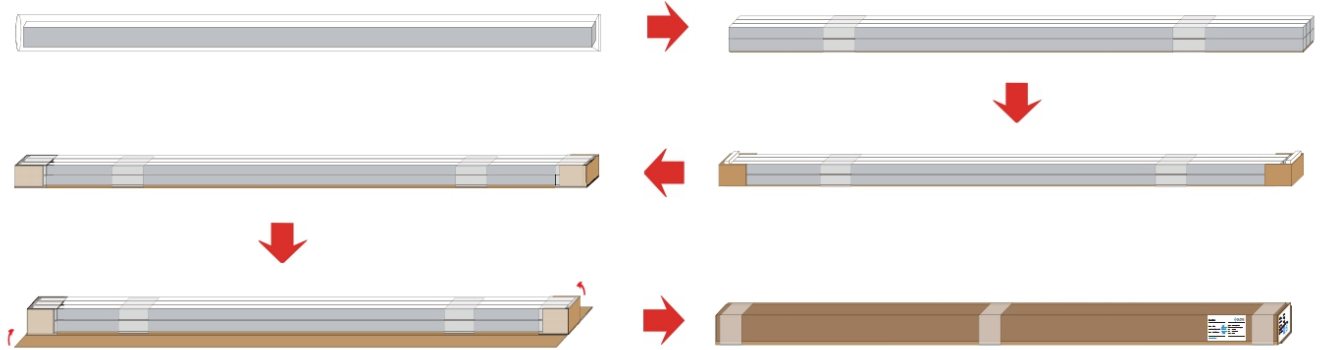

Item	Type	Size(mm)	NW(kg)	GW(kg)	Content
Profile and cover	Packing box	2580*270*115mm	12.87	15.87	6pcs/box